

Fiber & Fabric Craft Festival

May 1-3, 2026

Deadline To Receive Discounted Rates:
April 16, 2026

VU Case Rentals



Please Mail, E-mail or Fax Completed Form to RES:

9291 West Bryn Mawr, Rosemont, IL 60018 | Fax 847-696-9797
customerservice@rosemontexpo.com

POWER IS NOT INCLUDED IN ORDER

VISION CASE

Full Vision Case Includes
1-8" and 1-10" glass shelf with adjustable brackets, 26" high front glass display section

1/2 Vision Case Includes
1-10" glass shelf with adjustable brackets, 18" high front glass display section

1/4 Vision Case Includes
12" high front glass display section

	QTY.	DISCOUNT	STANDARD	TOTAL
5 ft. Full Vision Case	_____	\$540.00	\$620.00	\$ _____
6 ft. Full Vision Case	_____	\$565.00	\$645.00	\$ _____
5 ft. 1/2 Vision Case	_____	\$515.00	\$595.00	\$ _____
6 ft. 1/2 Vision Case	_____	\$540.00	\$620.00	\$ _____
5 ft. 1/4 Vision Case	_____	\$490.00	\$570.00	\$ _____
6 ft. 1/4 Vision Case	_____	\$515.00	\$595.00	\$ _____



Full Vision Case



1/2 Vision Case

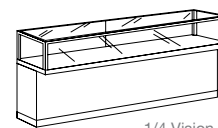

1/4 Vision Case

CORNER VISION CASE

Full Corner Vision Case Includes
1-8" and 1-10" glass shelf with adjustable brackets, 26" high front glass display section

1/2 Corner Vision Case Includes
1-10" glass shelf with adjustable brackets, 18" high front glass display section

1/4 Corner Vision Case Includes
12" high front glass display section

	QTY.	DISCOUNT	STANDARD	TOTAL
Full Corner Vision Case	_____	\$515.00	\$595.00	\$ _____
1/2 Corner Vision Case	_____	\$490.00	\$570.00	\$ _____
1/4 Corner Vision Case	_____	\$490.00	\$570.00	\$ _____

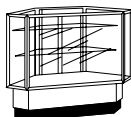

Full Corner Vision Case

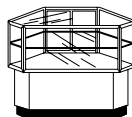

1/2 Corner Vision Case

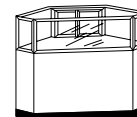

1/4 Corner Vision Case

WALL & TOWER CASE

Wall Case Includes
48"L x 20"D x 66"H, with 4-12" glass shelves, adjustable brackets, lights, locks and 60" high sliding glass doors

Tower Case Includes
20"L x 20"D x 80"H, with 3 glass shelves, lights and locks

	QTY.	DISCOUNT	STANDARD	TOTAL
Solid Wall Case	_____	\$590.00	\$670.00	\$ _____
See-Thru Wall Case	_____	\$565.00	\$645.00	\$ _____
Tower Case	_____	\$615.00	\$695.00	\$ _____

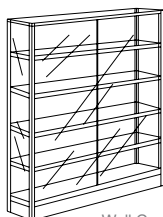

Wall Case

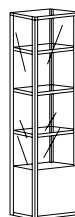

Tower Case

ORDER TOTAL \$ _____

ADDITIONAL INFORMATION

- All showcases are 20" D x 38" H, have lights, locks, sliding mirror doors, grey exterior, off-white interior aluminum frames.
- 4' showcases available upon request. (limited quantities)
- Electrical hook-up is not included. Please order the outlet from electrical contractor. **Cases require a standard electrical service outlet 1-1000 watts**
- A \$50.00 charge per showcase for late orders and changes made at show site.
- All keys must be left with showcase or a charge of \$10.00 will be assessed.
- A \$20.00 charge per additional shelf or size change of shelf.
- Shelf placement is exhibitors responsibility.

Company Name: _____ Phone #: _____ Fax #: _____

Address: _____ City: _____ State: _____ Zip: _____

Authorized By (print): _____ Signature: _____ Booth #: _____

Order Summary and Payment Sheet MUST accompany this order. All terms and conditions as outlined on the Order Summary and Payment Sheet have been reviewed and understood.

RES Address: 9291 West Bryn Mawr, Rosemont, IL 60018 • RES Telephone: 847-696-2208 • RES Fax: 847-696-9797